

PROPOSED LEEUWENFONTEIN QUARRY

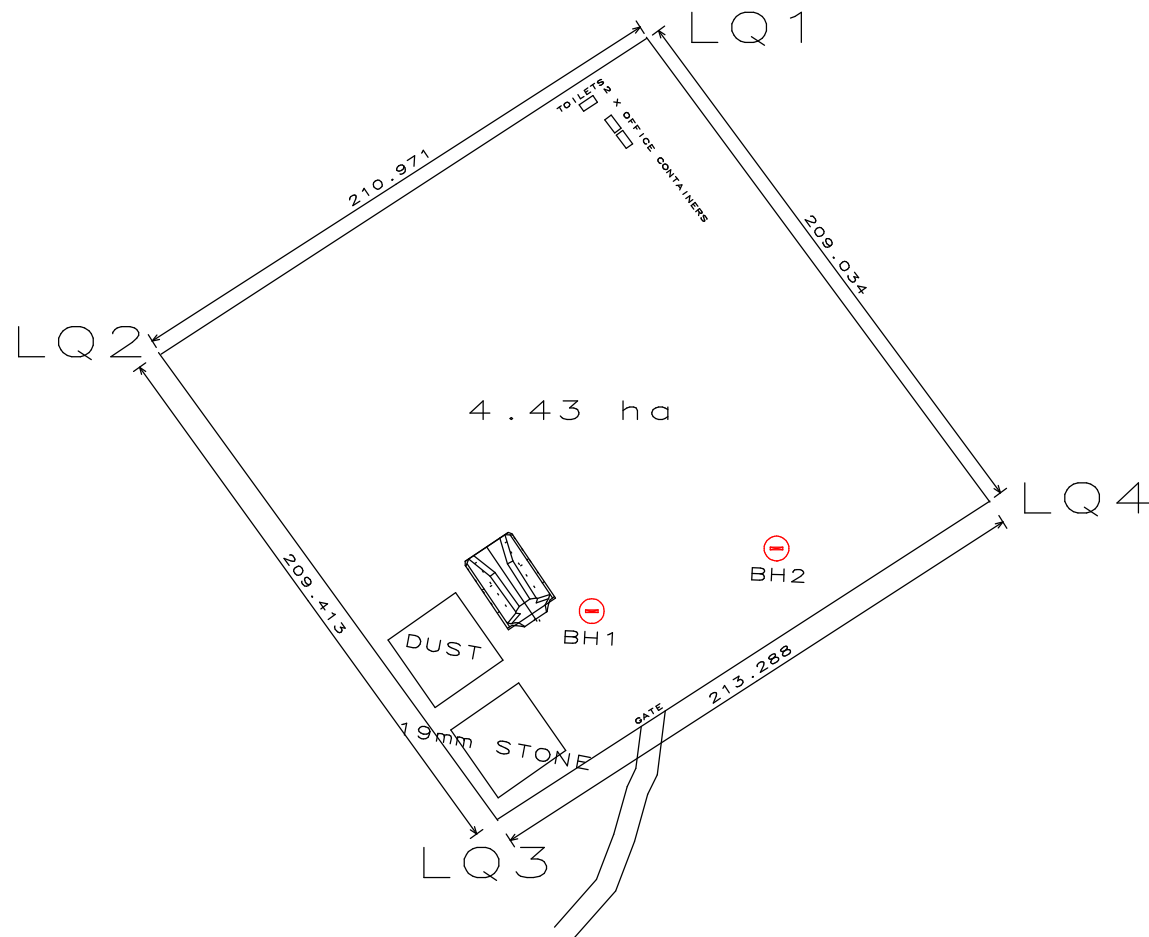

PROPOSED QUARRY AREA IS 4.43 HA
PROPOSED QUARRY POSITION

Code	Lat.DecimalDeg	Long.DecimalDeg
LQ1	-31.66733985	23.67437161
LQ2	-31.66837912	23.67250825
LQ3	-31.66990346	23.67381181
LQ4	-31.66884886	23.67569267

THE QUARRY WILL BE ACCESSABLE THROUGH EXCISTING
FARM ROADS FROM THE R63

THERE WILL BE TWO STOCKPILES. A DUST AND A 19mm STONE STOCKPILE

THERE WILL ALSO BE THE FOLLOWING ON SITE :

- TWO BOREHOLES SITUATED AT THE PROPOSED QUARRY
- TWO OFFICE CONTAINERS
- ABLUTION FACILITY

BOREHOLE POSITIONS

Borehole 1	-31.6692180	23.6741711
------------	-------------	------------

Borehole 2	-31.6690091	23.6748781
------------	-------------	------------

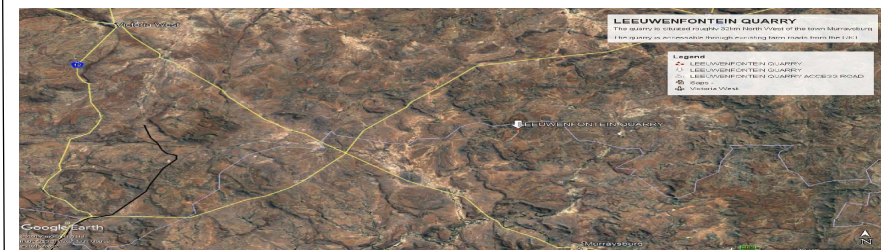

DRAWN BY
Hannes vd Berge
CONCOR
INFRASTRUCTURE

APPROVED BY
REGIONAL MANAGER
of the DMR

DRAWN FOR
CONCOR
INFRASTRUCTURE

PROJECT
LEEUWENFONTEIN QUARRY
SCALE : 1 / 2750
DATE 23/3/2021

NOTES
MISTHOEK TRUST
LEEUEWENFONTEIN nr 6
MURRAYSBURG DISTRICT
BEAUFORT WES MUNICIPALITY
SYSTEM S – 360 – L023 – WGS